

技术说明

1. 单关节均配单维力传感器;
2. 臂展: 666mm;
3. 额定负载: 3KG;
4. 自重: 17KG;
5. 抱闸类型: 24/12VDC电磁摩擦式;
6. 中间过线通孔最大尺寸: $\varnothing 7$ mm;

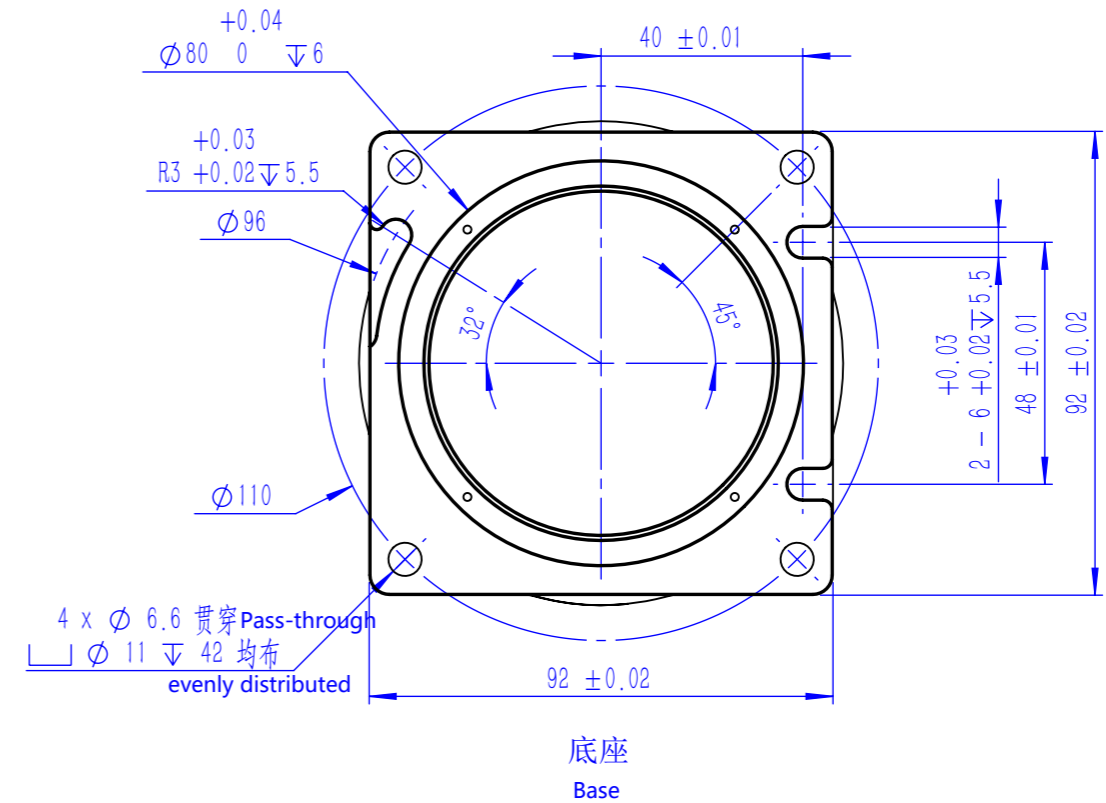
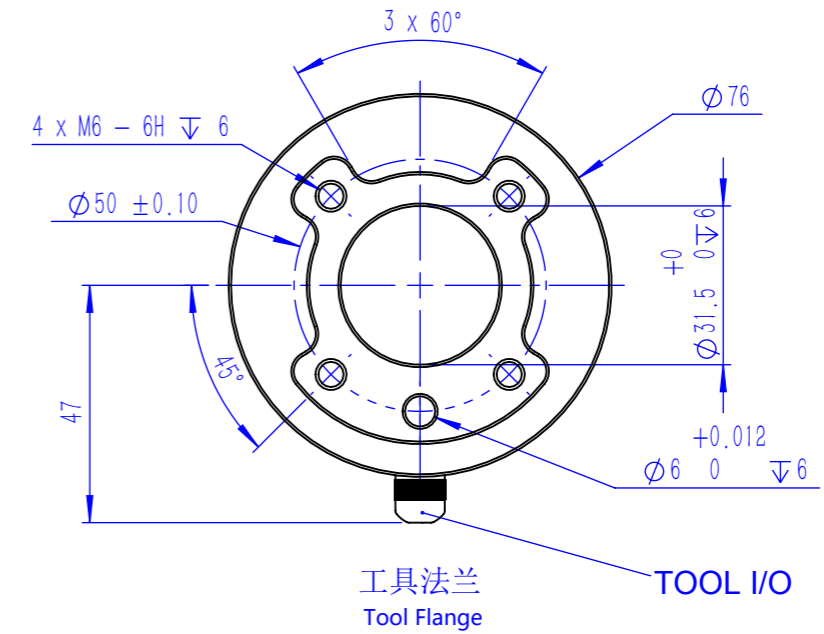

Technical Description

1. Each joint is equipped with a single-axis force sensor.
2. Arm span: 666mm.
3. Rated load: 3KG.
4. Weight: 17KG.
5. Brake type: 24/12VDC electromagnetic friction type.
6. Maximum size of the through-hole in the middle: $\varnothing 7$ mm.

TR 泰科机器人
TECH ROBOTS

☎ 400-856-5198

✉ sales@techsoft-robots.com

🌐 www.techsoft-robots.com