

信号线电缆与电源电缆  
Signal line cables and power cables

12XM3-6H 均布  
Evenly distributed

固定端  
Fixed terminal

12XM3-6H 均布  
Evenly distributed

输出端  
output terminal

信号线电缆与电源电缆  
Signal line cables and power cables

结构组成=谐波减速器+电机(带增量编码器)+制动器+输出绝对值编码器+伺服驱动器  
Component = harmonic reducer + motor (with incremental encoder) + output absolute encoder + servo drive

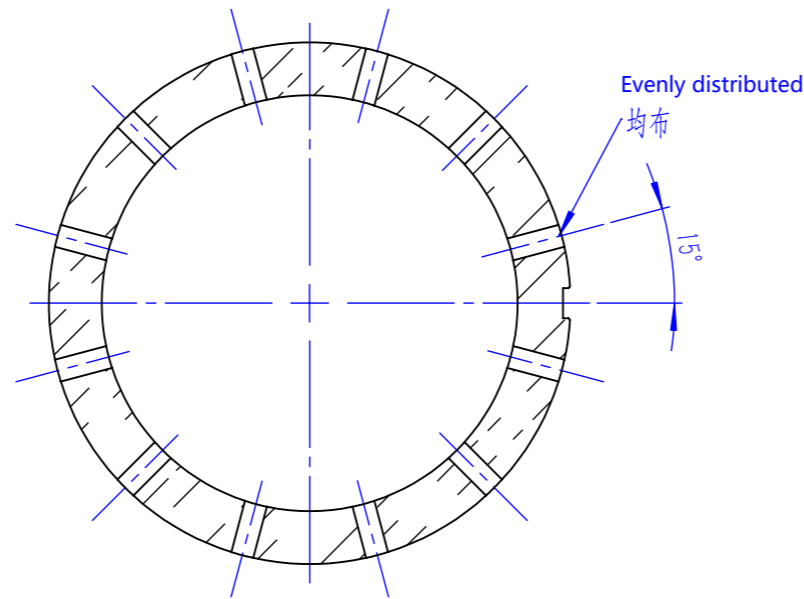

安装孔位分布图  
Installation Hole Distribution Diagram

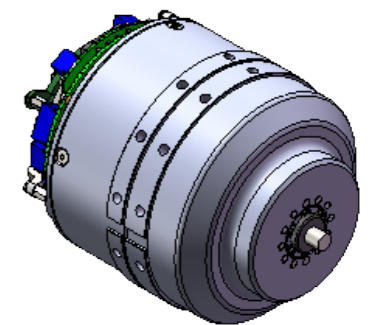
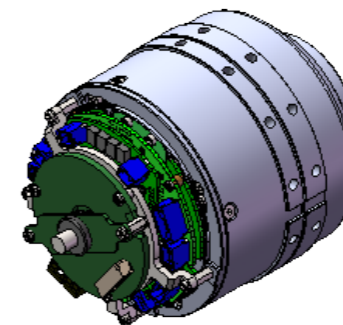

技术说明

1. 紧固螺钉需采用12.9级或以上螺钉并按标准拧紧;
2. 中间过线通孔最大尺寸: 5mm;

Technical Description

1. Fastening screws should be Grade 12.9 or above and tightened according to standard;
2. Maximum size of intermediate through-hole: 5mm;

机械参数 Mechanical Parameters	单位 Units	数值 Values
减速器速比 Reducer Ratio	—	100
减速器背隙 Reducer Backlash	arcsec	≤20
平均负载转矩 Average Load Torque	N·m	7
启停容许转矩 Start/Stop Allowable Torque	N·m	18
最大瞬时转矩 Maximum Instantaneous Torque	N·m	25
额定转速 Rated Speed	rpm	32
最大转速 Maximum Speed	rpm	45
关节重量 Joint Weight	kg	<0.73
关节直径 Joint Diameter	mm	69
关节长度 Joint Length	mm	86

电气参数 Motor Parameters	单位 Units	数值 Values
极对数 Number of Poles	—	10
额定功率 Rated Power	W	100
额定电压 Rated Voltage	VDC	48
额定电流 Maximum Power	Arms	3.8
额定转速 Rated Speed	rpm	3500
额定转矩 Rated Torque	N·m	0.3
峰值扭矩 Peak Torque	N·m	0.7
转矩常数 Torque constant	N·m/A	0.088
反电势系数 Back Electromotive Force Coefficient	V/krpm	5.3
抱闸 Brake	—	永磁式制动器 Permanent Magnet Brake
输出端反馈 Output feedback	—	17bit单圈绝对值 17-bit single-turn absolute value
电机反馈 Motor feedback	—	增量编码器8000P/R Incremental encoder 8000 P/R
通讯接口 Communication Interface	—	EtherCAT/CANopen



400-856-5198

sales@techsoft-robots.com

www.techsoft-robots.com